

**PROPOSED LANDUSE MAP**  
**Sambalpur Development Authority (SDA)**

Mouza: Garmunda; P.S. : Hirakud No.6 (4/5)

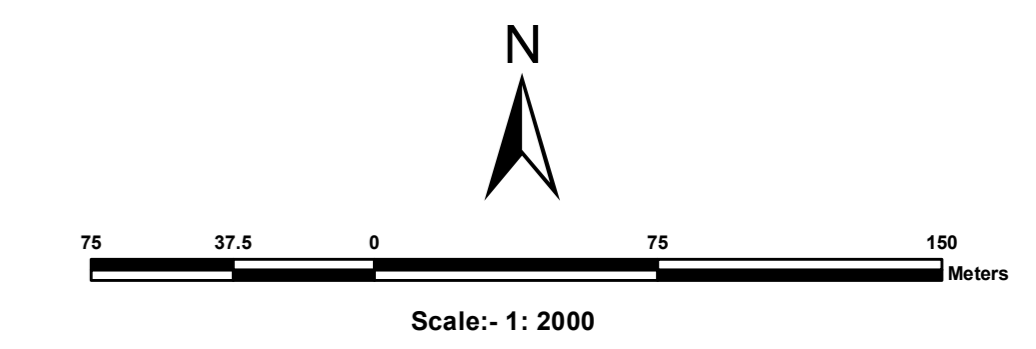

**LEGEND**

- Residential Use Zone
- Commercial Use Zone
- Industrial Use Zone
- Public and Semi-Public Use Zone
- Utilities & Services Use Zone
- Recreational ( & Open Space) Use Zone
- Transportation Use Zone
- Agriculture & Allied Use Zone
- Water Bodies Use Zone
- Railwayline
- Existing Road
- Existing Bridge
- Proposed Road
- Proposed Bridge
- Comprehensive Development Plan (SDA) Boundary
- Municipal Boundary
- Mouza Boundary
- Zone Boundary
- Ward Boundary
- Revenue Settlement Boundary
- Village Road
- Plot Boundary
- Dosimali
- Trisimali
- Mustakilchand
- Railway Pillar/Other Pillar
- Government Land

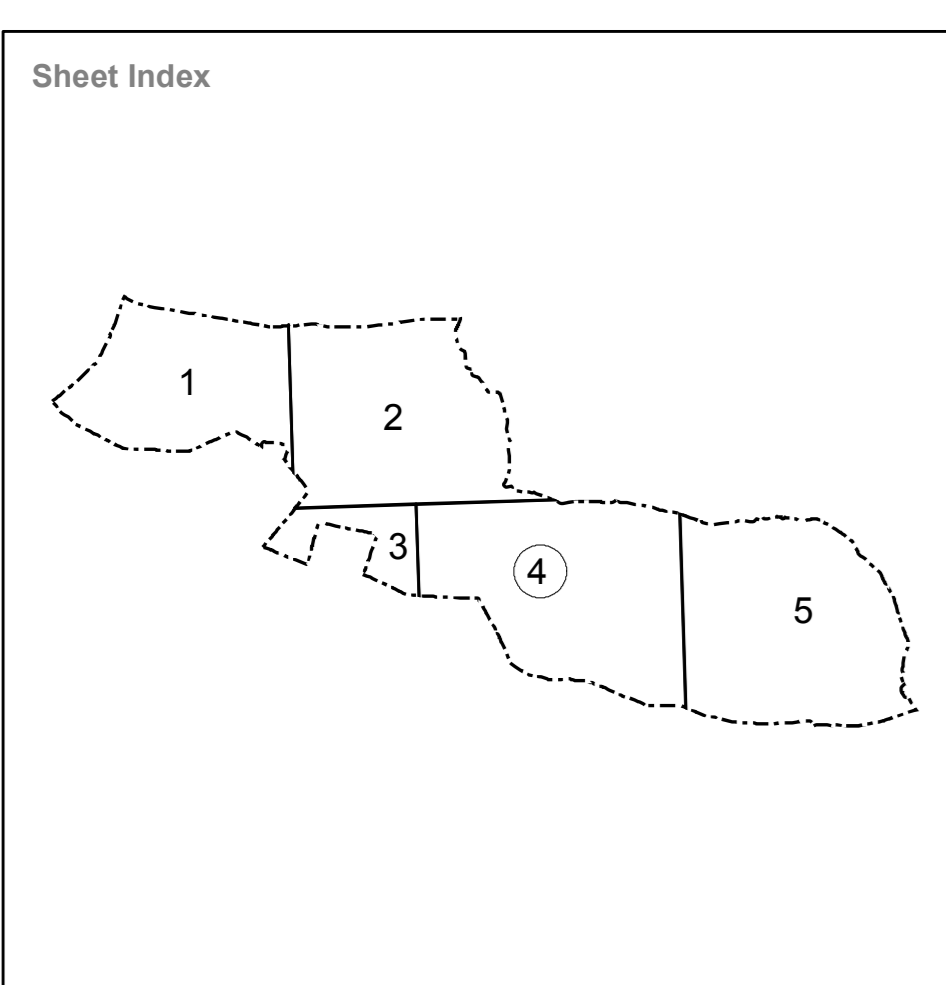
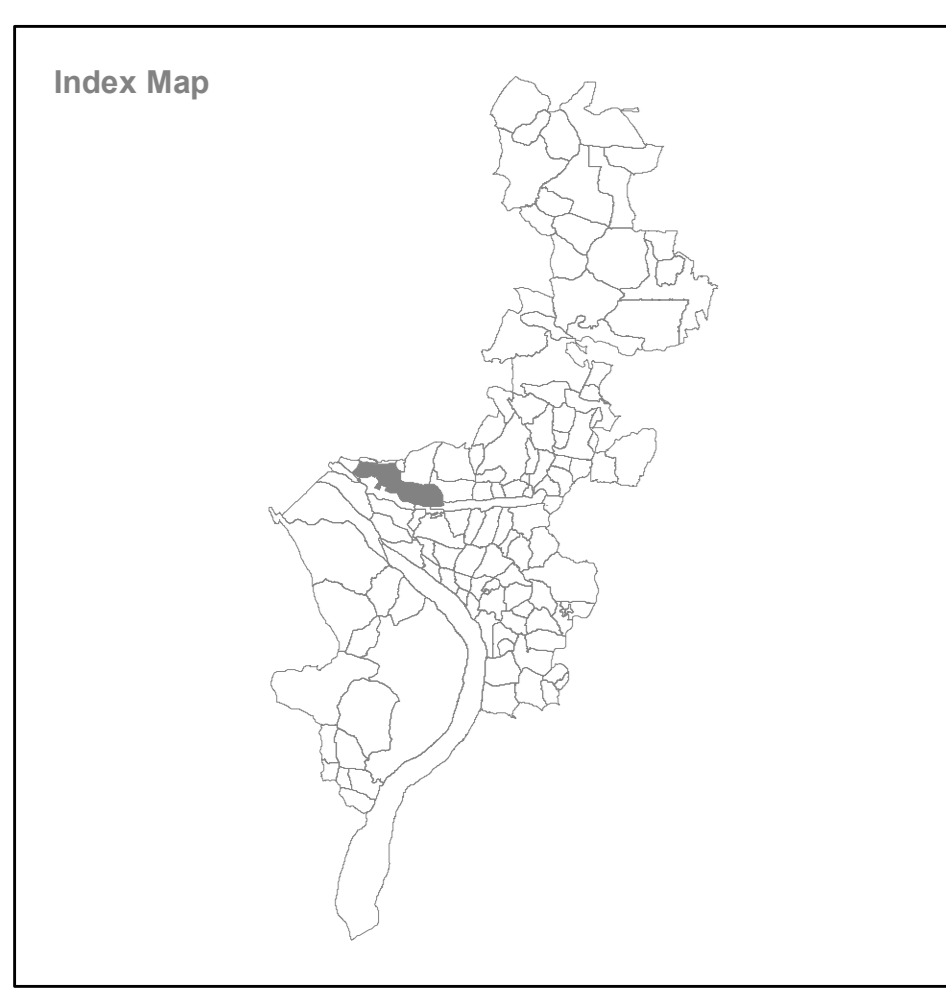

<p>Source/ Database Used :</p> <p>Satellite Data : World View-1 (PAN)                  Cadastral Data : Year-1981-82                  Ground Truthing : August 2010</p>	<p>Village Name : Garmunda                  Sheet No.4</p> <p>Tahasil Name : Sambalpur</p> <p>Prepared by :</p>
<p>Guideline : Urban GIS Database Development for                  CDP/ Master Plan Preparation</p> <p>Directorate of Town Planning                  Deptt. of Housing &amp; Urban Development                  Govt. of Orissa</p>	<p><b>Gujarat Industrial and                  Technical Consultancy                  Organisation, Ahmedabad</b></p> <p><b>Sambalpur Development                  Authority, Sambalpur</b></p>