

PROPOSED LANDUSE MAP Sambalpur Development Authority (SDA)

Mouza: Dengsargi; P.S. : Sambalpur No.5 (1/3)

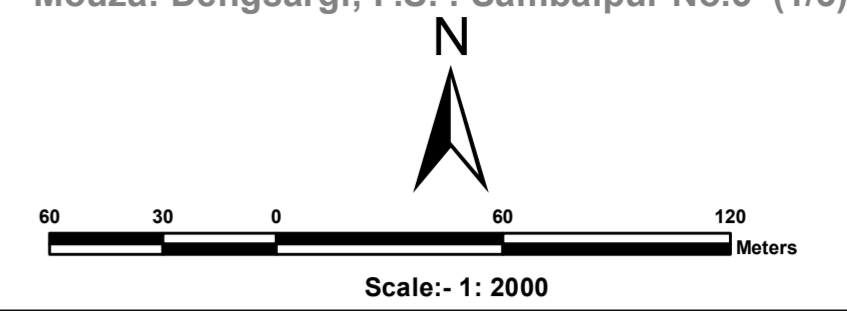

L E G E N D

- Residential Use Zone
- Special Area Use Zone
- Commercial Use Zone
- Industrial Use Zone
- Public and Semi-Public Use Zone
- Utilities & Services Use Zone
- Recreational (& Open Space) Use Zone
- Transportation Use Zone
- Agriculture & Allied Use Zone
- Water Bodies Use Zone
- Railwayline
- Existing Road
- Existing Bridge
- Proposed Road
- Proposed Bridge
- Comprehensive Development Plan (SDA) Boundary
- Municipal Boundary
- Mouza Boundary
- Zone Boundary
- Ward Boundary
- Revenue Settlement Boundary
- Village Road
- Plot Boundary
- Dosimali
- Trisimali
- Mustakilchand
- Railway Pillar/Other Pillar
- G Government Land

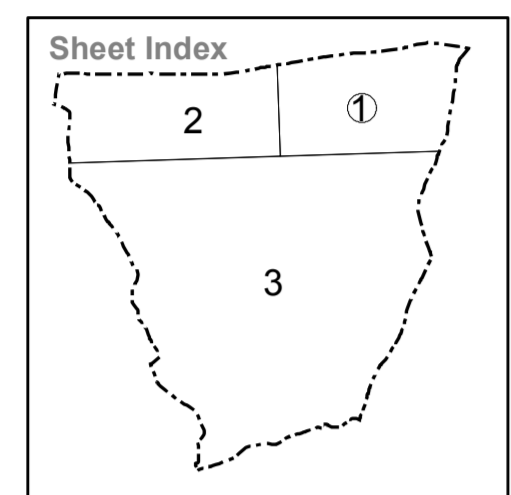
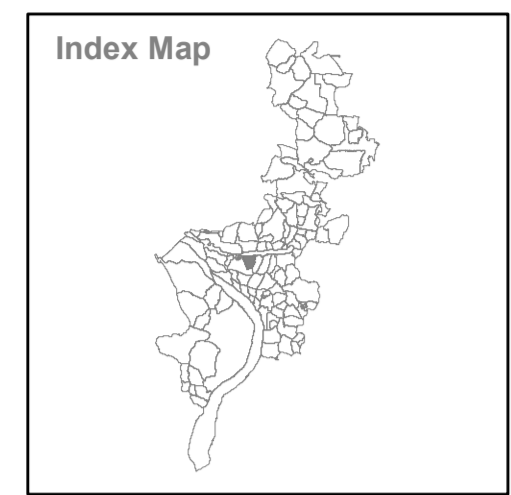
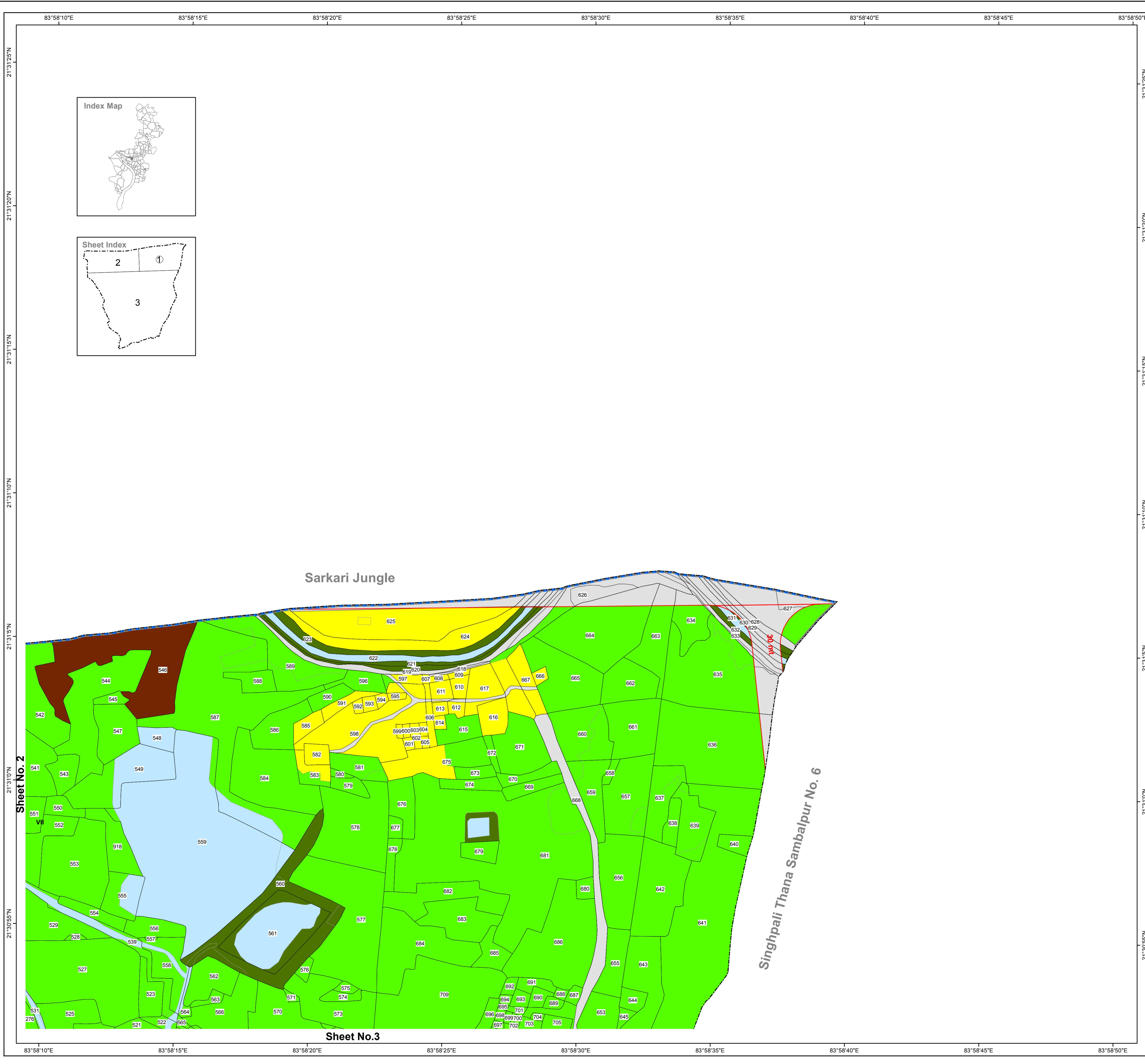

| | |
|---|---|
| <p>Source/ Database Used :</p> <p>Satellite Data : World View-1 (PAN) Cadastral Data : Year-1981-82 Ground Truthing : August 2010</p> | <p>Village Name : Dengsargi Sheet No.1</p> <p>Tahasil Name : Sambalpur</p> |
| <p>Guideline : Urban GIS Database Development for CDP/ Master Plan Preparation</p> <p>Directorate of Town Planning Deptt. of Housing & Urban Development Govt. of Orissa</p> | <p>Prepared by :</p> <p>Gujarat Industrial and Technical Consultancy Organisation, Ahmedabad</p> <p>Sambalpur Development Authority, Sambalpur</p> |